

Gingerbread Man

Here's what you need to make one:

- 1 – 4 x 4 brown round brick
- 4 – 1 x 4 brown bricks, modified log
- 3 – 1 x 2 brown bricks, modified log
- 2 – 2 x 6 brown plates
- 1 – 1 x 2 brown plate with one stud on top
- 2 – eyes
- 3 – 1 x 1 white round plates
- 1 – 1 x 1 red round plate
- 1 – 2 x 2 plate with a curved end and a hole



Step 1: Attach the brown bricks to a 2 x 6 brown plate as shown. The log modified bricks make it possible to angle the arms and legs slightly.



Step 2: Add the second 2 x 6 plate on top of the body. Attach the red nose to the 1 x 2 plate with one stud on top and add it to the face. Add the eyes and white buttons.

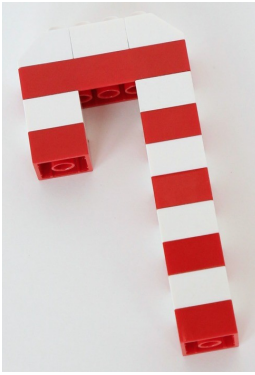

Candy Cane

To build the candy cane, you will need:

2 – 2 x 2 white slopes

6 – 2 x 2 white bricks

1 – 2 x 6 red brick

5 – 2 x 2 red bricks

Reindeer Ornament

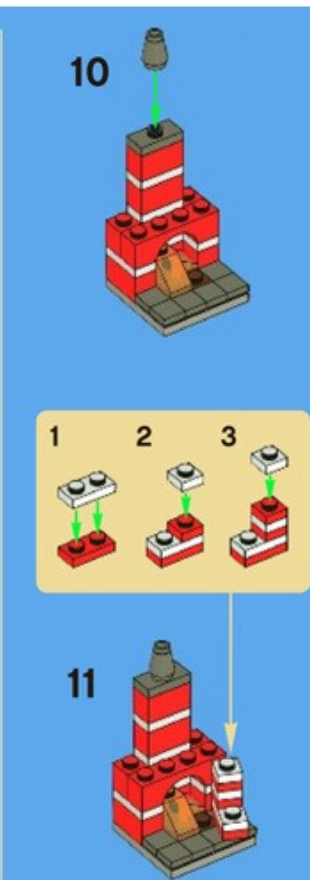
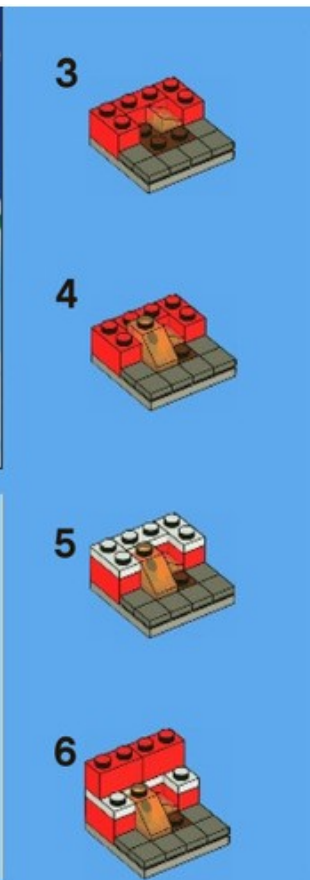
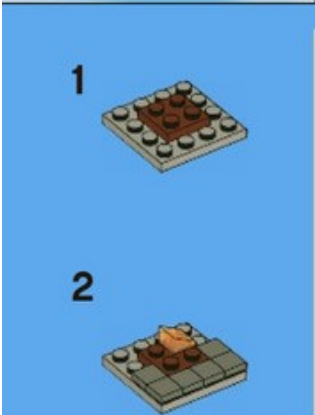
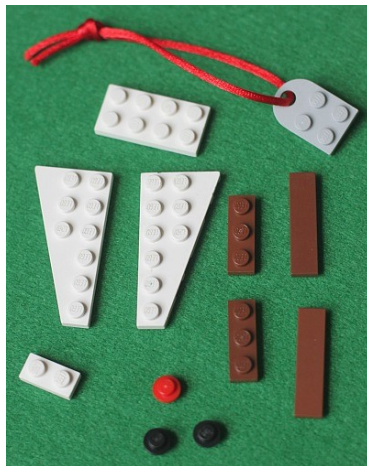
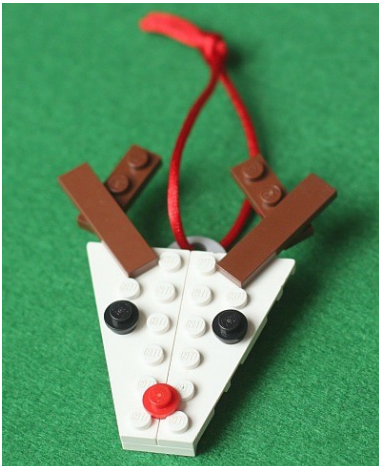

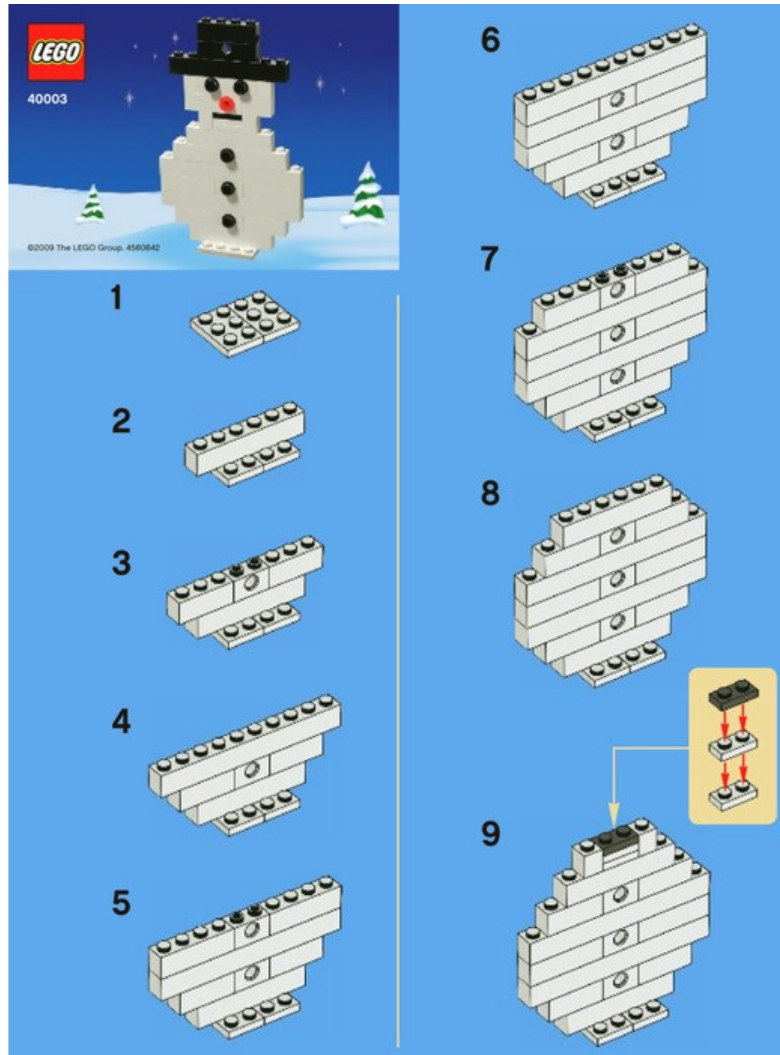
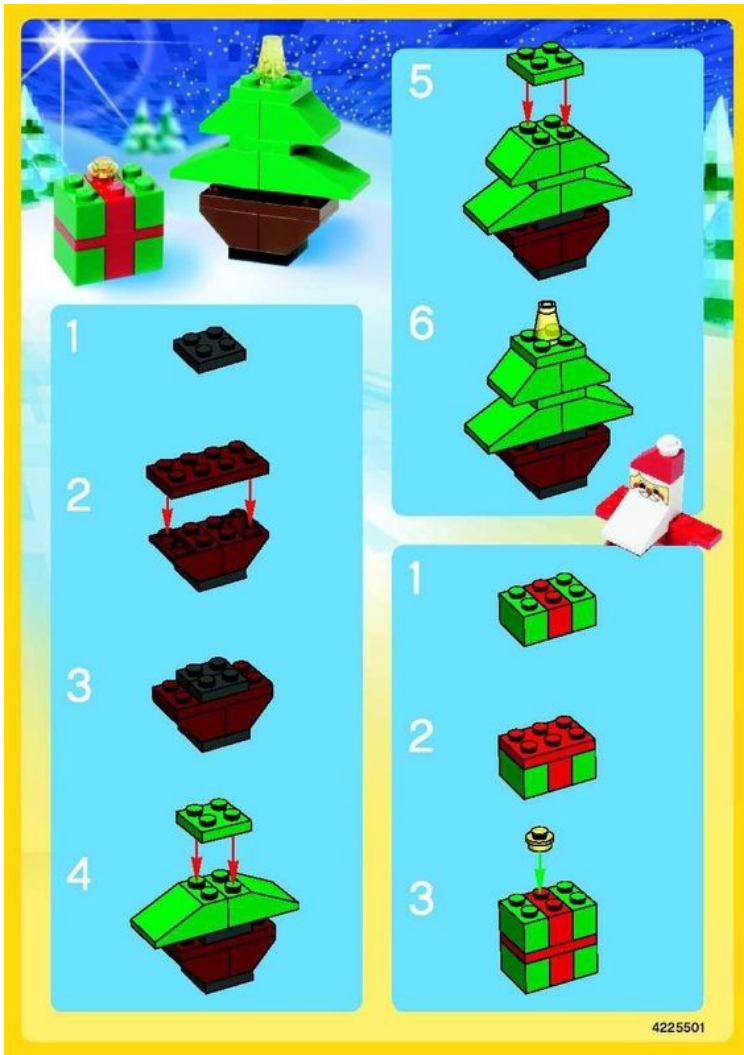

- Santa is 15 bricks high including the fur on the top of his hat.
- He uses black, white, red, brown and tan bricks.
- He starts with 1 flat black 4x4 plate for boot soles.
- Use two 2x3 black bricks for his boots (facing forward.)
- Two layers of black 2x4 bricks on top of that.
- Next is a bit of fur – 1 white 2x4 brick.
- 2 layers of 2x4 red for the pants.
- 1 layer of 2x4 black for his belt.
- 2 layers of 2x4 red bricks for his body and one 2x2 for the neck.
- His head consists of one 2x4 white brick for the beard – keep it as one piece if you have it because it looks better.
- His face is 2 2x2 tan bricks – you could also use a 2x4.
- His hat is one 2x4 red brick. On top of that add 2 2x2 red 45 degree roof tiles (see picture for slant.) Add four white slope 30 pieces 1x1x 2/3.
- The arms and shoulders of santa starting at the top of the shoulders is made with two red bricks with bow 1/3, two red 2x2 bricks, and one 2x2 white brick. Do this for each arm.
- His mittens are made from a red 2x2 slope 45 and a red 2x1. (one for each side.)
- Santa's sack is made with brown bricks. Use two 2x2 45 degree inverted slopes, two 2x4 bricks, two 2x2 45 degree roof tiles with two 1x2 curved (you can use regular) bricks on top. Attach sack to Santa's mitten.



- 1
- 2
- 3
- 4

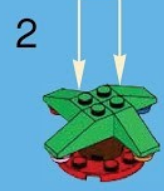
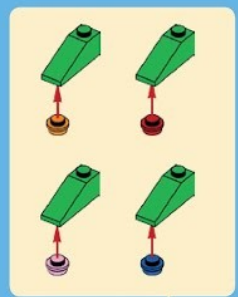

LEGO.com/service
LEGO and the LEGO logo are trademarks of the LEGO Group. ©2015 The LEGO Group. 6112672

